

NEWMAN, COMLEY & RUTH P.C.

ATTORNEYS AND COUNSELORS AT LAW

601 MONROE STREET, SUITE 301

P.O. BOX 537

JEFFERSON CITY, MISSOURI 65102-0537

TELEPHONE: (573) 634-2266

FACSIMILE: (573) 636-3306

www.ncrpc.com

ROBERT K. ANGSTEAD
ROBERT J. BRUNDAGE
MARK W. COMLEY
LANETTE R. GOOCH
CATHLEEN A. MARTIN

MARTIN A. MILLER
STEPHEN G. NEWMAN
JOHN A. RUTH
ALICIA EMBLEY TURNER

January 9, 2007

FILED²

JAN 09 2007

The Honorable Colleen M. Dale
Missouri Public Service Commission
P.O. Box 360
Jefferson City, MO 65102-0360

**Missouri Public
Service Commission**

Re: Lake Region Water & Sewer Company
Case No. WA-2005-0463; Tracking No. YS-2007-0460

Dear Judge Dale:

Please find enclosed the following substitute tariff sheets:

PSC MO No. 2, Second Revised Sheet No. 2, Replacing First Revised Sheet No. 2;
PSC MO No. 2, Second Revised Sheet No. 4, Replacing First Revised Sheet No. 4.

These sheets are being filed at the suggestion of Staff and should be substituted for their original counterparts filed on January 4, 2007.

Would you please bring this filing to the attention of the appropriate commission personnel.
Thank you.

Very truly yours,

NEWMAN, COMLEY & RUTH P.C.

By:

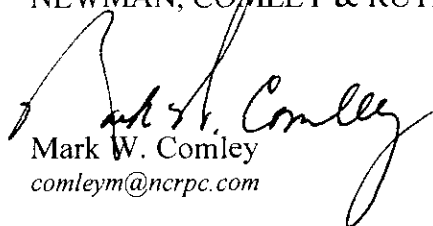
Mark W. Comley
comleym@ncrpc.com

MWC:ab

Enclosure

cc: Office of Public Counsel
General Counsel's Office
Dale Johansen
John R. Summers

P.S.C. MO NO. 2 SECOND REVISED SHEET NO. 2

CANCELLING P.S.C. MO NO. 2 FIRST REVISED SHEET NO. 2

LAKE REGION WATER AND SEWER COMPANY: SHAWNEE BEND SERVICE AREA

FOR SEWER SERVICE

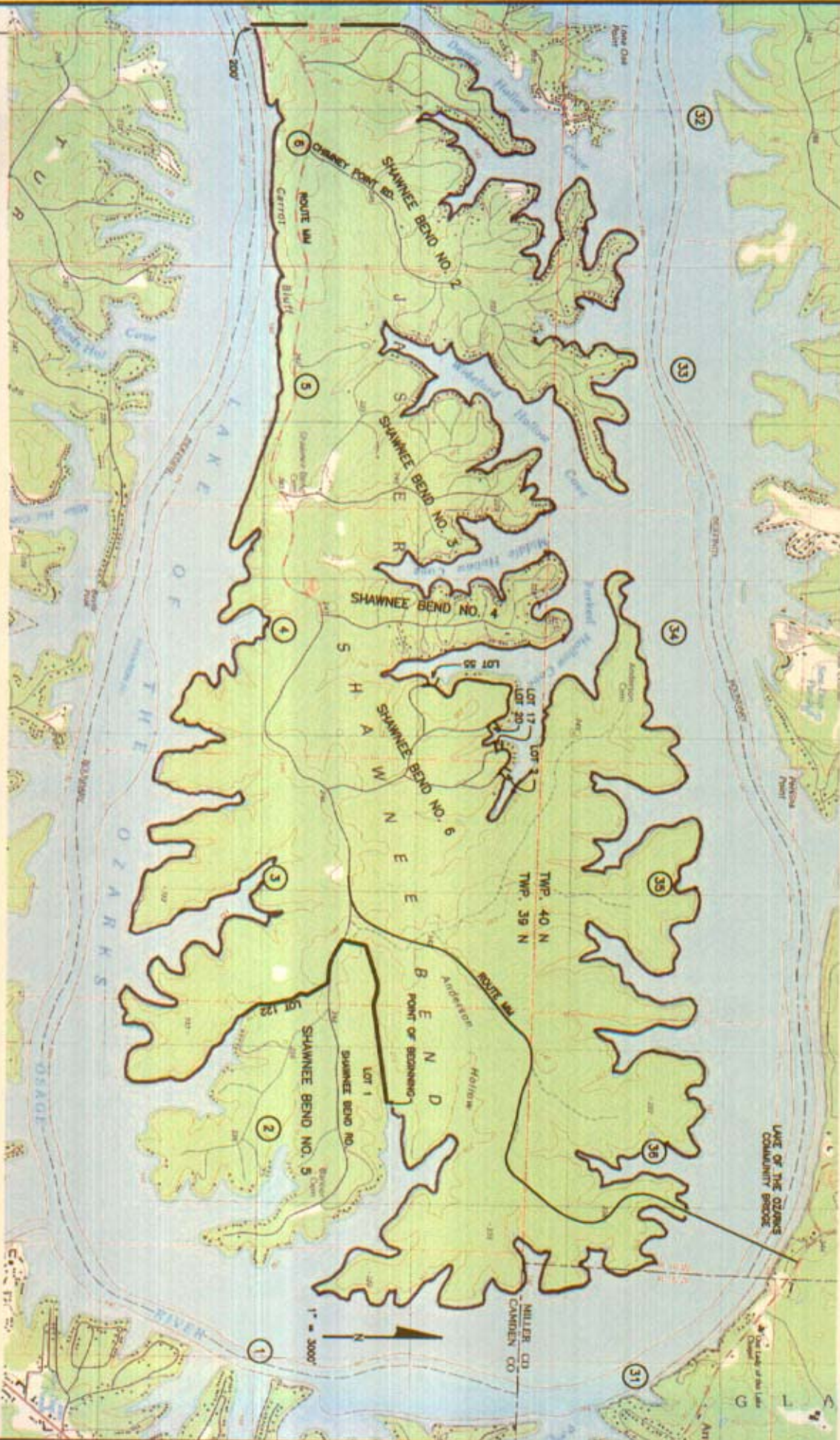

R. 17 W
R. 16 W

DATE OF ISSUE 1-4-2007 DATE EFFECTIVE 2-3-2007

ISSUED BY:

NAME OF OFFICER: John Summers TITLE: General Manager ADDRESS: P.O. Box 608 Lake Ozark, Missouri 65049

Lake Region Water & Sewer Company

For: Missouri Service Areas

**Rules Governing Rendering of
Sewer Service****Legal Description of the Service Area: Sewer – Shawnee Bend**

+

Lake Region Water & Sewer Company general description for sewer service area on Shawnee Bend, Lake of the Ozarks, Camden and Miller Counties, Missouri.

Generally includes all of the Shawnee Bend peninsula east of and including Section 6, Township 39 North, Range 16 West, excluding the subdivision of Shawnee Bend No. 5; and, lots 2 thru 17 and lots 20 thru 55 of the Shawnee Bend No. 6 subdivision, more particularly described as:

Beginning at the shoreline (662 contour) at the northerly most corner of Lot 1 of Shawnee Bend No. 5, then following the north line of Lot 1 to the north right-of-way of Shawnee Bend Road, then following this right-of-way in an easterly direction to a point adjacent to the northwest corner of Lot 122 Shawnee Bend No. 5, then crossing Shawnee Bend Road to the said northwest corner of Lot 122, then following the westerly line of Lot 122 southerly to the shoreline (662 contour) then following the shoreline westerly through Section 2, Section 3, Section 4, section 5 and Section 6 to a point 200 feet west of the west section line of Section 6, the Rangeline, Township 39 north, Range 16 west, then leaving the shoreline and going north on a line parallel and 200 feet west of said Rangeline to the shoreline on Davey Hollow Cove, then following the shoreline in a generally and resultant easterly direction (to and through Section 6, Section 5, Section 4, Section 3, section 2, and Section 1 of Township 39 North, Range 16 West, and through Section 32, Section 33, Section 34, Section 35 and Section 36 of Township 40 North, Range 16 West, and through Section 31, Township 40 North, Range 15 West) to the Point of Beginning.

* Indicates New Rate or Text

+ Indicates Changed Rate or Text

Issue Date: January 4, 2007

Effective Date: February 3, 2007

Issued By: John R. Summers, General Manager

Lake Region Water & Sewer Company
P.O. Box 9, Lake Ozark, MO 65049